

F.R.L. Hava Kontrol Ünitesi / F.R.L. Air Control Unit

F.R.L. 20-C20 / F.R.L. 20-C20



F20



R20



L20



FR20



FRL20



C20



FRL20K



C20-AS1
C20-Manifold

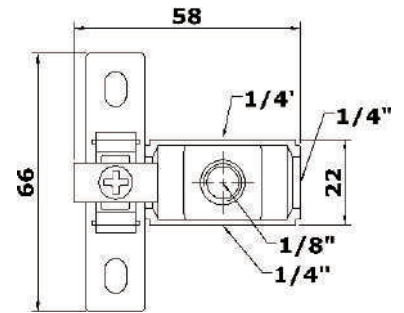

20 Serisi Çizim / 20 Series Drawing

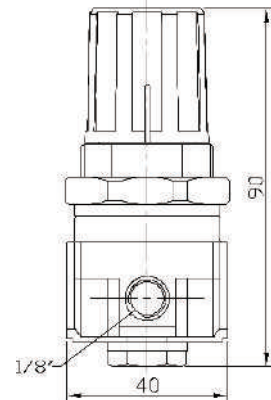
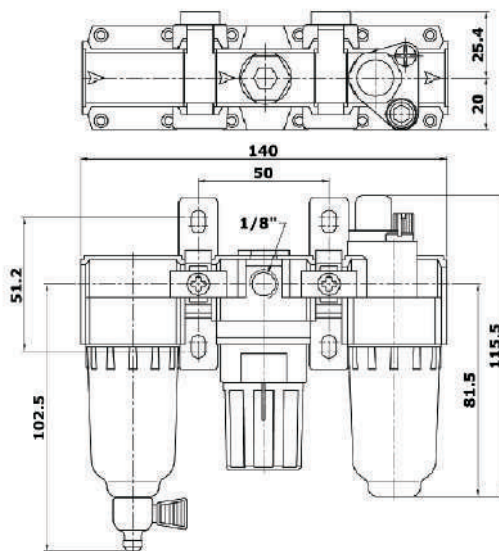
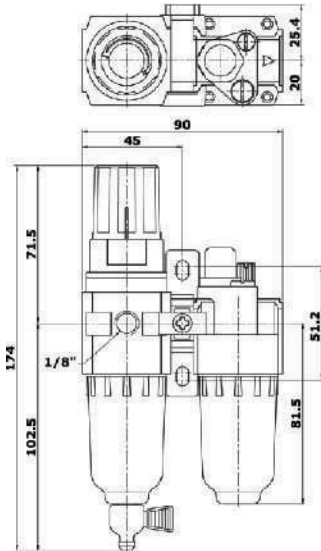

F.R.L. Hava Kontrol Ünitesi / F.R.L. Air Control Unit

F.R.L. 20-C20 / F.R.L. 20-C20

Özellikler / Specification

Part No.	C201		C202		FRL212
	FRL201		FRL202		
Description	Air				
Medium	Air				
Port Size (PT.NPT)	1/8"		1/4"		1/4"
Filter Element	5 μ				
Proof Input Pressure	Psi	150		280	
	Mpa	1		2	
Proof Output Pressure	Psi	145		232	
	Mpa	0.99		1.6	
Max Flow(L/min)	1000		1100		1100
Operation Temperature Range	5 ~ 60 °C				
Drain Capacity	15ml				
Oil Capacity	30ml				
Minimum Dripping Flow Rate (L/min(ANR))*	15				
Recommendable Lubricants	ISO VG-32				
Meet the international norms	Air Filter:ISO 5782-1 & -2 / JIS B 8371 Regulator:ISO 6953-1 & -2 / JIS B 8372 Air Filter+Regulator:ISO 5782-1 & -2 / ISO 6953-1 & -2 JIS B 8372 / JIS B 8371 Lubricator:ISO 6301-1 & -2 / JIS B 8378				
More Options					
Air Filter	F201		F202		F212
Regulator	R201		R202		R212
Air Filter+Regulator	FR201		FR202		FR212
Lubricator	L201		L202		L212
Meet the international norms	Flow capacity : ISO 6358 / ISO 6953				

* The flow rate is 5 drops or greater/min under the following conditions: Inlet pressure of 0.5 MPa; Class 1 turbine oil (ISO VG32); Temperature at 20°C; Oil adjustment valve fully open.

* For a circuit that repeatedly turns ON and OFF on the outlet side, make the adjustment so that the average air consumption per minute becomes the minimum dripping flow rate or more.

* Lubriaction cannot be properly performed if the operating flow rate is too low. Select an appropriately size lubricator by referring to the minimum dripping flow rate provided in the catalog.

Özellikleri / Features

- 1.Compact design for limited space.
- 2.Easy installation
- 3.Cost effective

Sipariş Bilgisi/ Order Information

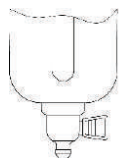
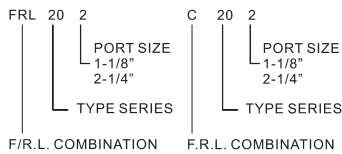

Semi-Auto Drain Valve



Auto Drain Valve

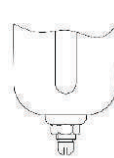

Manual Drain Valve

