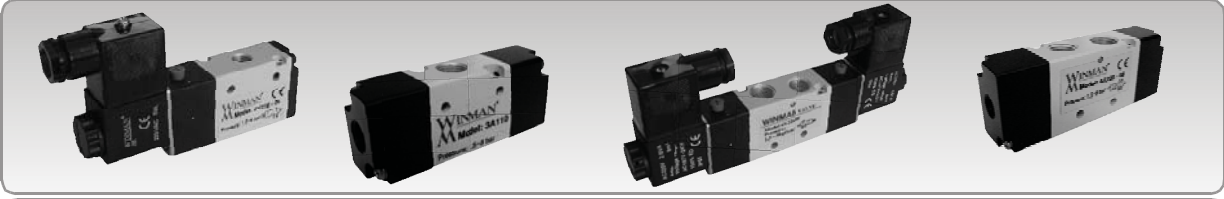
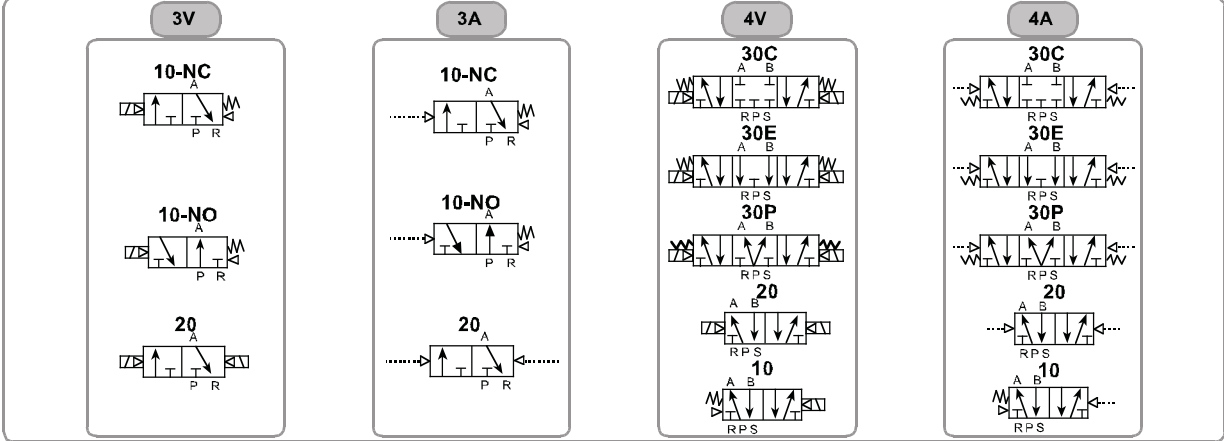
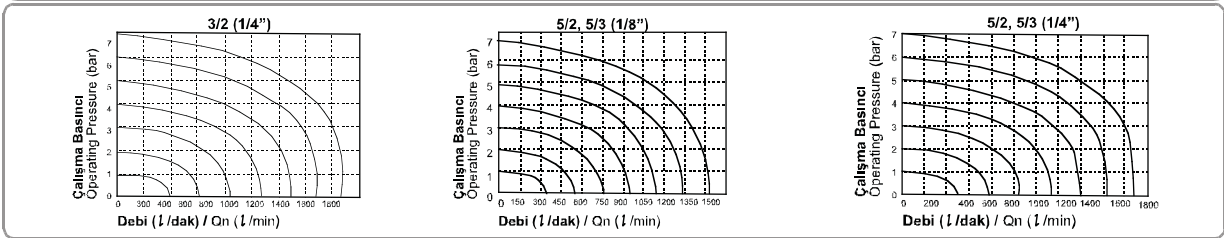

**200 Serisi Selenoid & Hava Kum. Valfler / 200 Series Solenoid & Pneu. Act. Valves**

**Semboller / Symbols**

**Özellikler / Specification**

Özellik / Item	Selenoid Pnömatik / Solenoid Pneumatic			
	Giriş = Çıkış = Egzost = 1/8" / In = Out = Exhaust = 1/8"		Giriş = Çıkış = Egzost = 1/4" / In = Out = Exhaust = 1/4"	
Bağlantı Ölçüsü / Port Size	40µ Filtrelenmiş Hava / Air (to be by 40µ Filter Element)			
Akışkan / Fluid	40µ Filtrelenmiş Hava / Air (to be by 40µ Filter Element)			
Valf Tipi / Valve Type	3/2	5/2	5/3	5/3
Orifis Çapı / Orifice Size	4 mm <sup>2</sup> Cv= 0.78		12 mm <sup>2</sup> Cv= 0.67	16 mm <sup>2</sup> Cv= 0.89
Yağlama / Lubrication	Gerektirmez / Not Required			
Basınç Aralığı / Pressure Range	1.5 ~ 8.0 bar / 0.15 ~ 0.8 MPa / 21 ~ 114 Psi			
Test Basıncı / Proof Pressure	12 bar / 1.2 MPa / 171 Psi			
Sıcaklık / Temperature	- 5 ~ 60 °C / 23 ~ 140 °F			
Voltaj Aralığı / Voltage Range	± 10%			
Max. Çalışma Frekansı / Max. Frequency	5 çevrim/sn / cycle/s	3 çevrim/sn / cycle/s	5 çevrim/sn / cycle/s	3 çevrim/sn / cycle/s
Güç Tüketimi / Power Consumption	AC220V: 2.0VA / AC110V: 2.5VA / AC24V: 3.5VA / DC24V: 3.0VA / DC12V: 2.5VA			
Yalıtım / Insulation	B Sınıfı / F Class			
Koruma / Protect	IP65 (DIN40050)			
Solet / Connection	DIN Terminal			
Min. Aktifleşme Zamanı (sn) / Min. Activating Time (sec)	0.05 sn / 0.05 sec			

**Akış Diyagramları / Flow Charts**

**Sipariş Kodu / Ordering Code**

3	V	2	20	06	NO	AC24V
Fonksiyon / Function	Pilot Tipi / Pilot Type	Seri / Serie	Valf Tipi / Valve Type	Bağlantı Ölçüsü / Port Size	Çalışma Tipi / Acting Type	Voltaj / Voltage
3: 3 Yol 2 Konum 3: 3 Port 2 Position	V: Selenoid Valf V: Solenoid Valve	2: 200 Serisi 2: 200 Series	10: Tek Etkili 10: Single Acting	06: 1/8"	Boş: Yok Empty: None (5/2, 5/3)	Boş: Yok Empty: None
			20: Çift Etkili 20: Double Acting			
4: 5 Yol 2 (3)Konum 4: 5 Port 2 (3) Position	A: Hava Kumandalı A: Pneumatic Valve		30C: 5/3 Kapalı Merkez 30C: 5/3 Closed Center	08: 1/4"	N.A.: Normalde Açık (3/2) N.O.: Normally Open	DC24V
			30E: 5/3 Egzost Merkez 30E: 5/3 Exhaust Center			
			30P: 5/3 Basınç Merkez 30P: 5/3 Pressure Center		N.K.: Normalde Kapalı (3/2) N.C.: Normally Closed	AC110V 50 Hz
						AC220V 50 Hz

200 Serisi Solenoid & Hava Kum. Valfler / 200 Series Solenoid & Pneu. Act. Valves

Teknik Çizimler / Technical Drawings

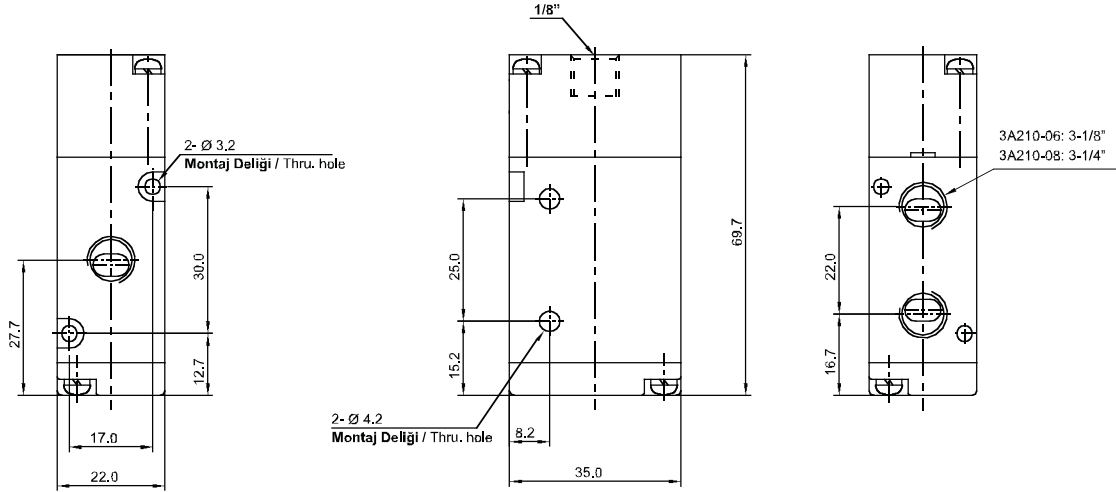
3A210



3A220

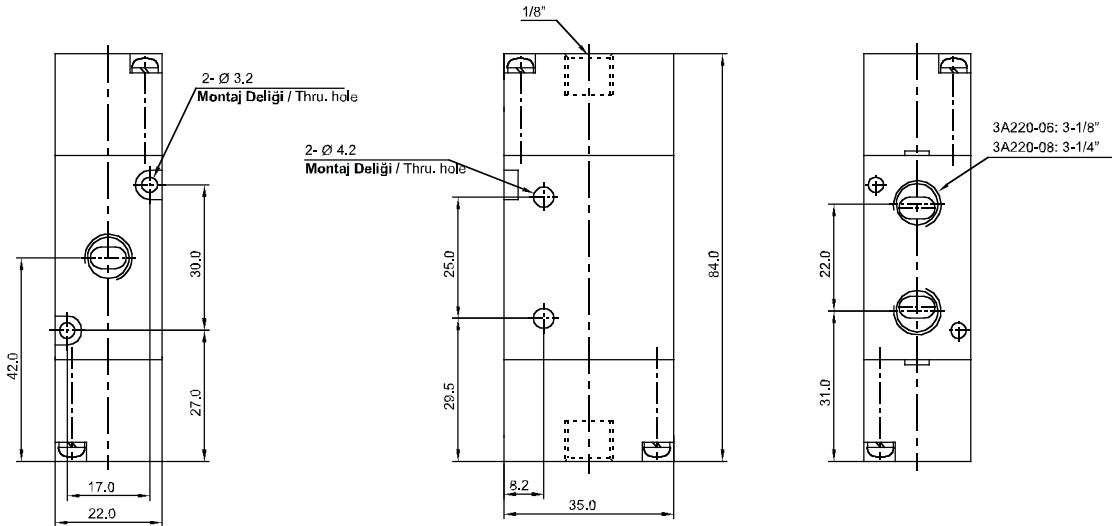

200 Serisi Solenoid & Hava Kum. Valfler / 200 Series Solenoid & Pneu. Act. Valves

Teknik Çizimler / Technical Drawings

3V210

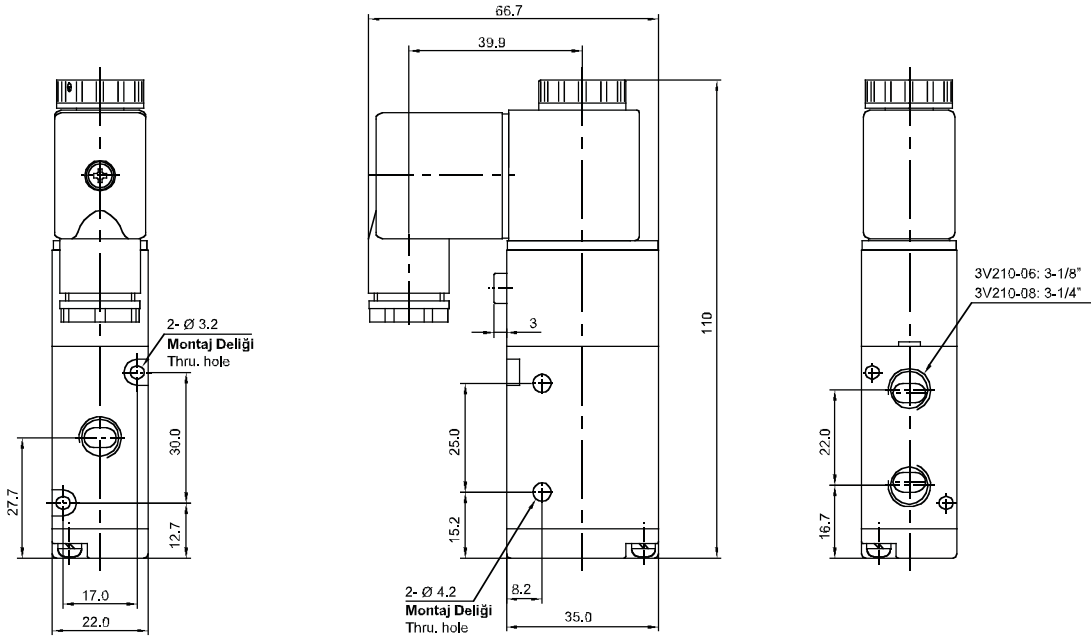

3V220

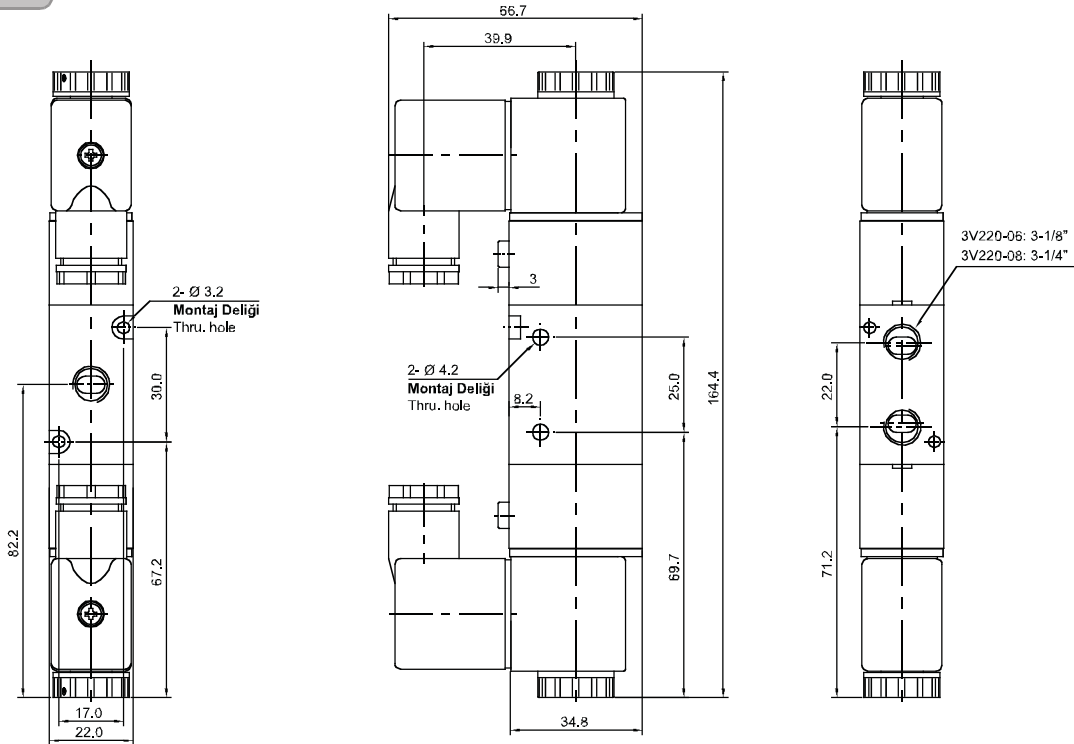

200 Serisi Solenoid & Hava Kum. Valfler / 200 Series Solenoid & Pneu. Act. Valves

Teknik Çizimler / Technical Drawings

4A210

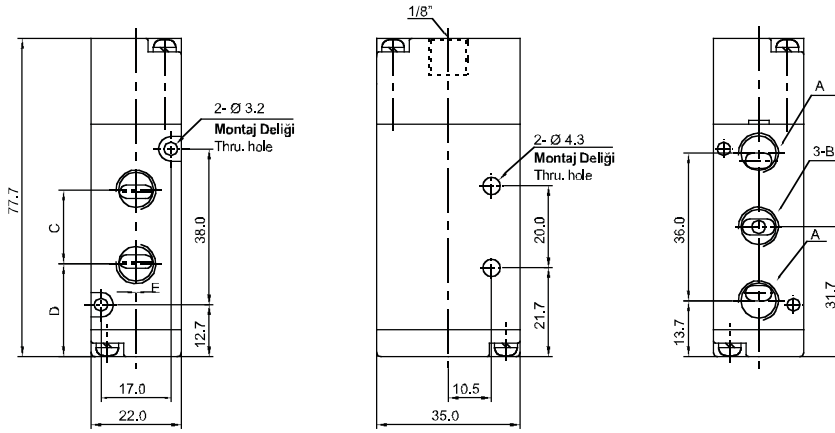

Parça / Model Item / Model	4A210-06	4A210-08
A	1/8"	1/8"
B	1/8"	1/4"
C	18	21
D	22.7	21.2
E	0	3

4A220

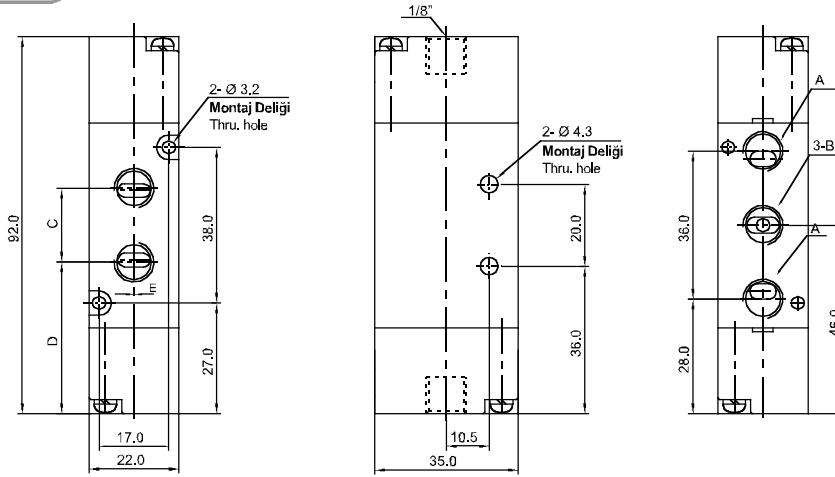

Parça / Model Item / Model	4A220-06	4A220-08
A	1/8"	1/8"
B	1/8"	1/4"
C	18	21
D	37	35.5
E	0	3

4A230

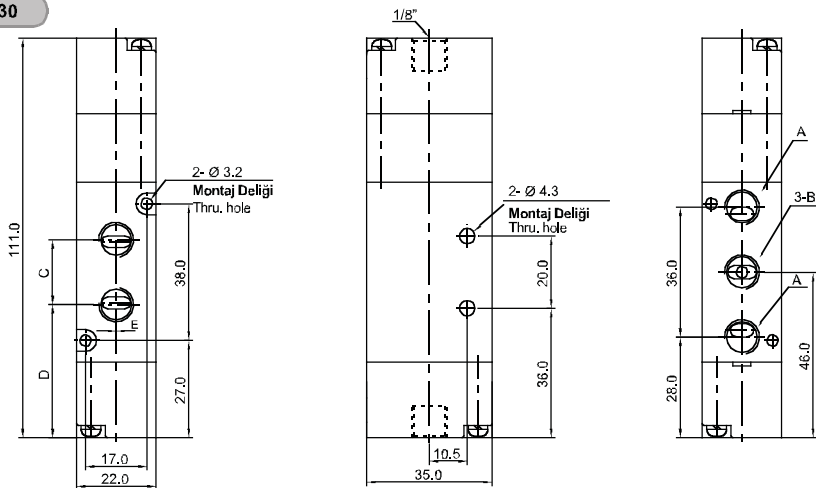

Parça / Model Item / Model	4A230-06	4A230-08
A	1/8"	1/8"
B	1/8"	1/4"
C	18	21
D	37	35.5
E	0	3

200 Serisi Solenoid & Hava Kum. Valfler / 200 Series Solenoid & Pneu. Act. Valves

Teknik Çizimler / Technical Drawings

4V210

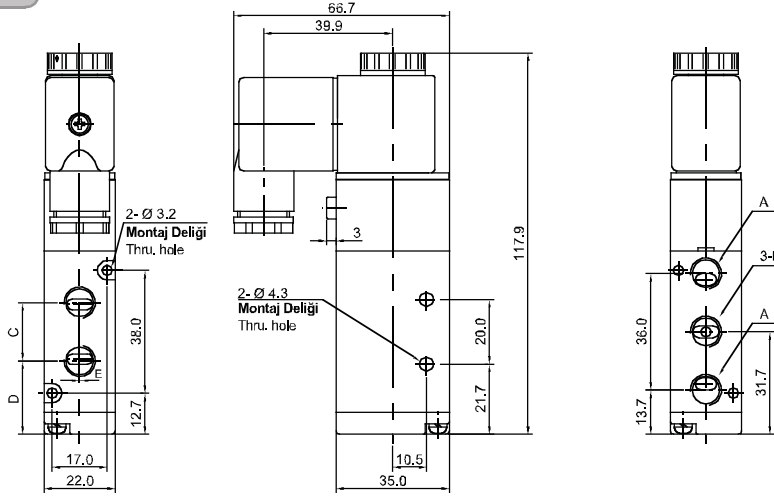

Parça / Model Item / Model	4V210-06	4V210-08
A	1/8"	1/8"
B	1/8"	1/4"
C	18	21
D	22.7	21.2
E	0	3

4V220

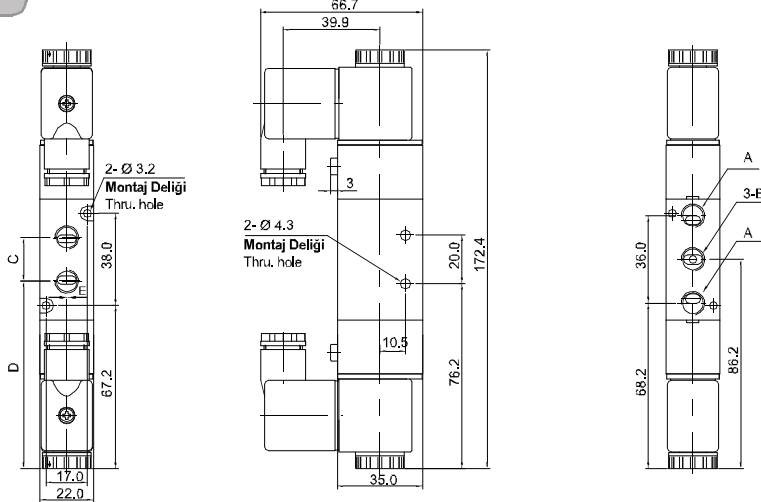

Parça / Model Item / Model	4V220-06	4V220-08
A	1/8"	1/8"
B	1/8"	1/4"
C	18	21
D	76	74.5
E	0	3

4V230

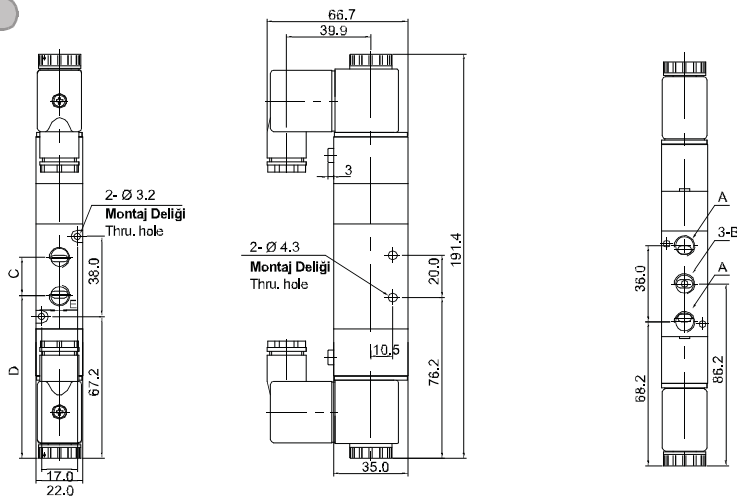

Parça / Model Item / Model	4V230-06	4V230-08
A	1/8"	1/8"
B	1/8"	1/4"
C	18	21
D	95	93.5
E	0	3