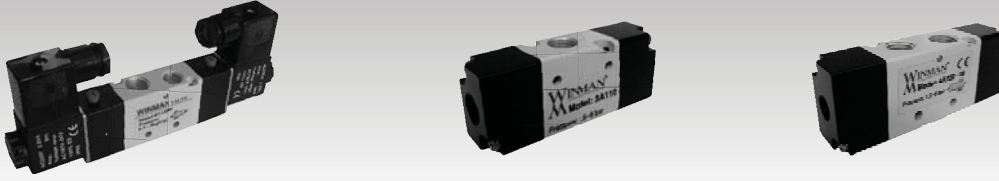
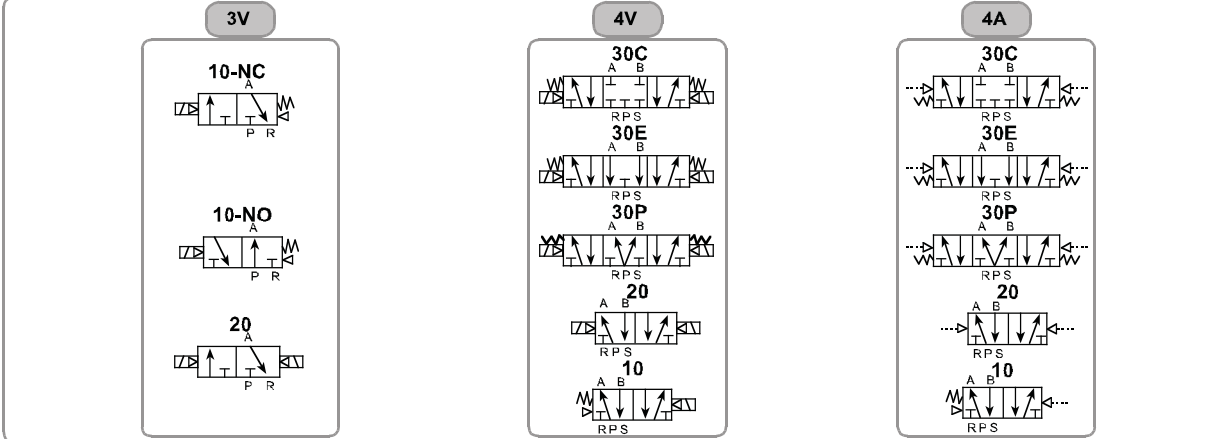
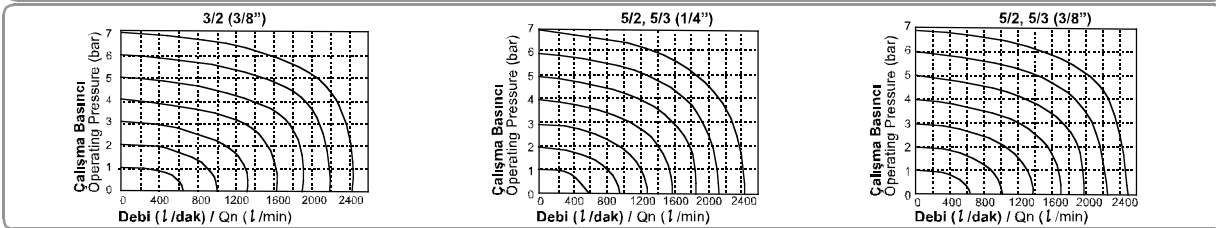

300 Serisi Selenoid & Hava Kum. Valfler / 300 Series Solenoid & Pneu. Act Valves

Semboller / Symbols

Özellikler / Specification

Özellik / Item	Selenoid Pnömatik / Solenoid Pneumatic					
Bağlantı Ölçüsü / Port Size	Giriş = Çıkış = Egzost = 1/4" / In = Out = Exhaust = 1/4"		Giriş = Çıkış = 3/8" Egzost = 1/4" / In = Out = 3/8" Exhaust = 1/4"			
Akışkan / Fluid	40µ Filtrelenmiş Hava / Air (to be by 40µ Filter Element)					
Valf Tipi / Valve Type	3/2	5/2	5/3	3/2	5/2	5/3
Orifis Çapı / Orifice Size	25 mm ² Cv = 1.39		18 mm ² Cv = 1.00	30 mm ² Cv = 1.67		18 mm ² Cv = 1.00
Yağlama / Lubrication	Gerektirmez / Not Required					
Basınç Aralığı / Pressure Range	1.5 ~ 8.0 bar / 0.15 ~ 0.8 MPa / 21 ~ 114 Psi					
Test Basıncı / Proof Pressure	12 bar / 1.2 MPa / 170 Psi					
Sıcaklık / Temperature	- 5 ~ 60 °C / 23 ~ 140 °F					
Voltaj Aralığı / Voltage Range	- 15 % ~ + 10 %					
Max. Çalışma Frekansı / Max. Frequency	5 çevrim/sn / cycle/s	4 çevrim/sn / cycle/s	3 çevrim/sn / cycle/s	5 çevrim/sn / cycle/s	4 çevrim/sn / cycle/s	3 çevrim/sn / cycle/s
Güç Tüketimi / Power Consumption	AC220V: 2.0VA / AC110V: 2.5VA / AC24V: 3.5VA / DC24V: 3.0 W / DC12V: 2.5 W					
Yalıtım / Insulation	F Sınıfı / F Class					
Koruma / Protect	IP65 (DIN40050)					
Soket / Connection	DIN Terminal					
Min. Aktifleşme Zamanı (sn) / Min. Activating Time (sec)	0.05 sn / 0.05 sec					

Akış Diyagramları / Flow Charts

Sipariş Kodu / Ordering Code

3	V	3	20	06	NO	AC24V
Fonksiyon / Function	Pilot Tipi / Pilot Type	Seri / Serie	Valf Tipi / Valve Type	Bağlantı Ölçüsü / Port Size	Çalışma Tipi / Acting Type	Voltaj / Voltage
3: 3 Yol 2 Konum 3: 3 Port 2 Position	V: Selenoid Valf V: Solenoid Valve	3: 300 Serisi 3: 300 Series	10: Tek Etkili 10: Single Acting	08: 1/4"	Boş: Yok Empty: None (5/2, 5/3)	Boş: Yok Empty: None
4: 5 Yol 2 (3)Konum 4: 5 Port 2 (3) Position	A: Hava Kumandalı A: Pneumatic Valve		20: Çift Etkili 20: Double Acting		10: 3/8"	N.A.: Normalde Açık N.O.: Normally Open (3/2)
		30C: 5/3 Kapalı Merkez 30C: 5/3 Closed Center	N.K.: Normalde Kapalı N.C.: Normally Closed (3/2)	AC24V 50 Hz		
			30E: 5/3 Egzost Merkez 30E: 5/3 Exhaust Center			AC110V 50 Hz
			30P: 5/3 Basınç Merkez 30P: 5/3 Pressure Center			AC220V 50 Hz

300 Serisi Solenoid & Hava Kum. Valfler / 300 Series Solenoid & Pneu. Act Valves

Teknik Çizimler / Technical Drawings

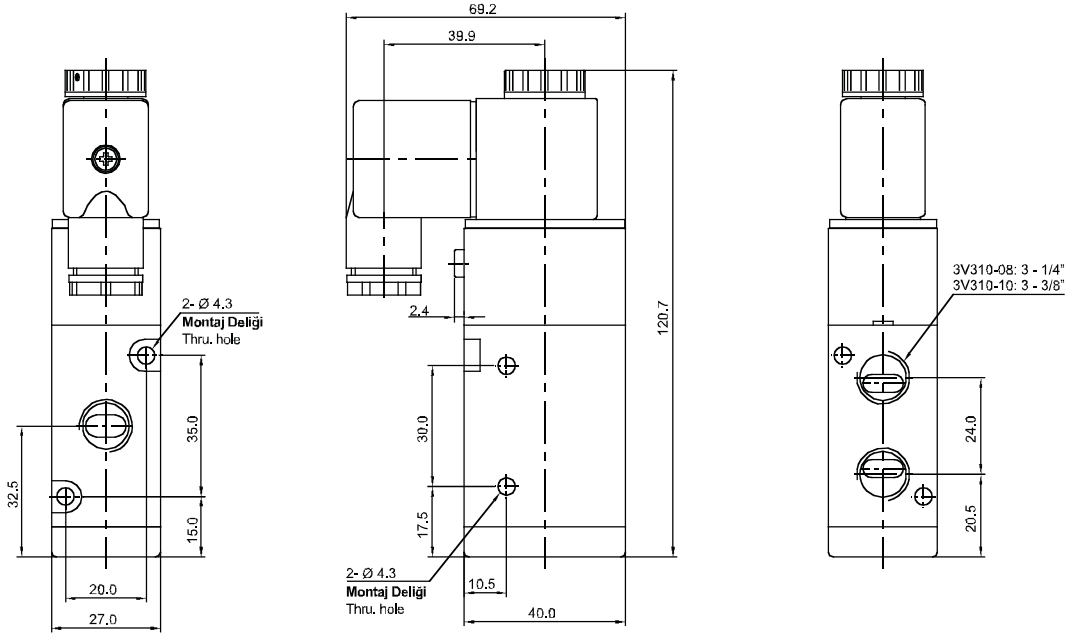
3V310



3V320

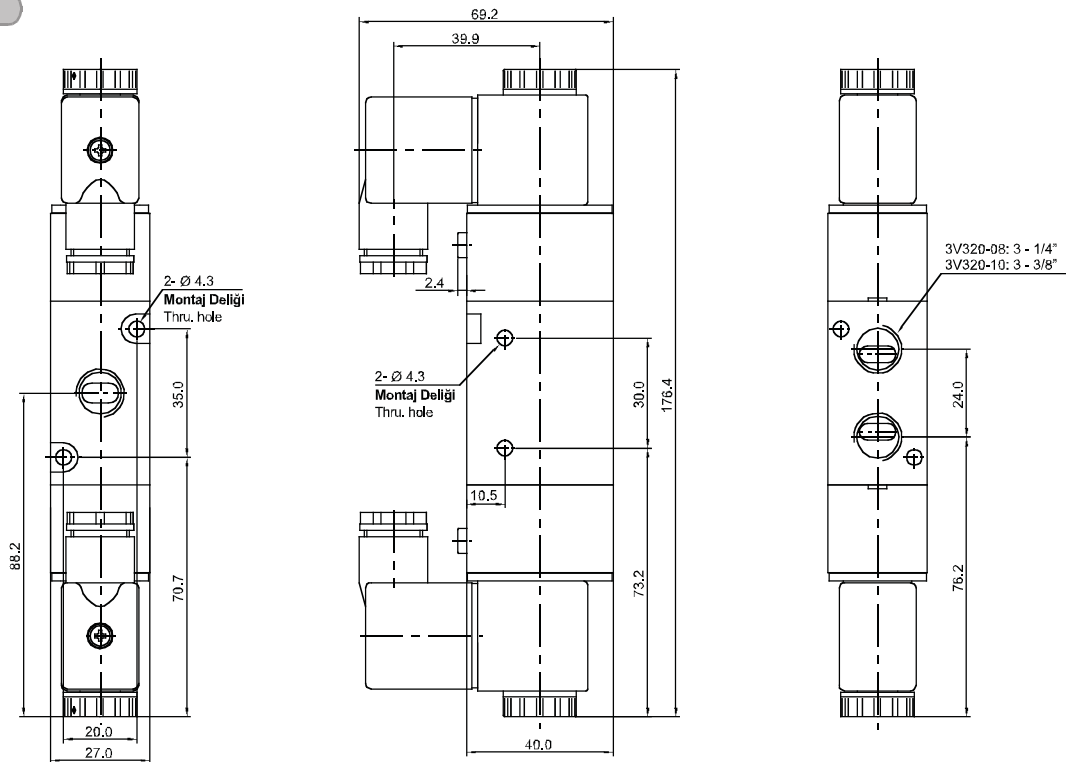

300 Serisi Solenoid & Hava Kum. Valfler / 300 Series Solenoid & Pneu. Act Valves

Teknik Çizimler / Technical Drawings

4A310

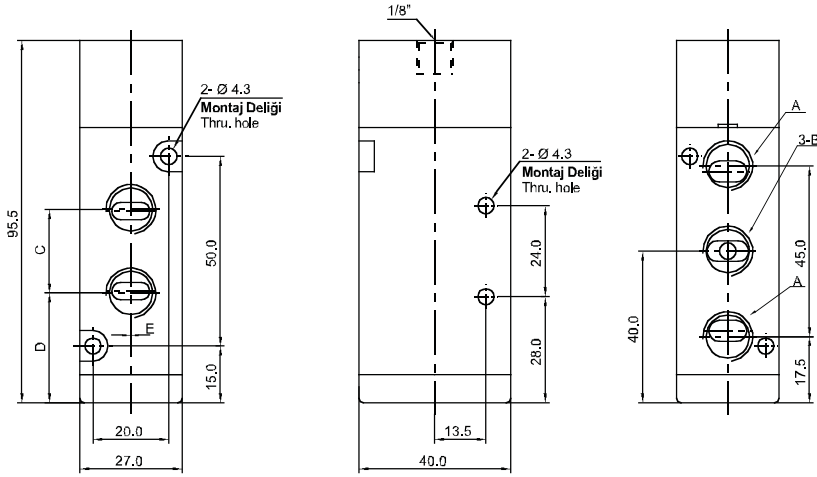

Parça / Model Item / Model	4A310-08	4A310-10
A	1/4"	1/4"
B	1/4"	3/8"
C	22	22
D	29	29
E	0	4

4A320

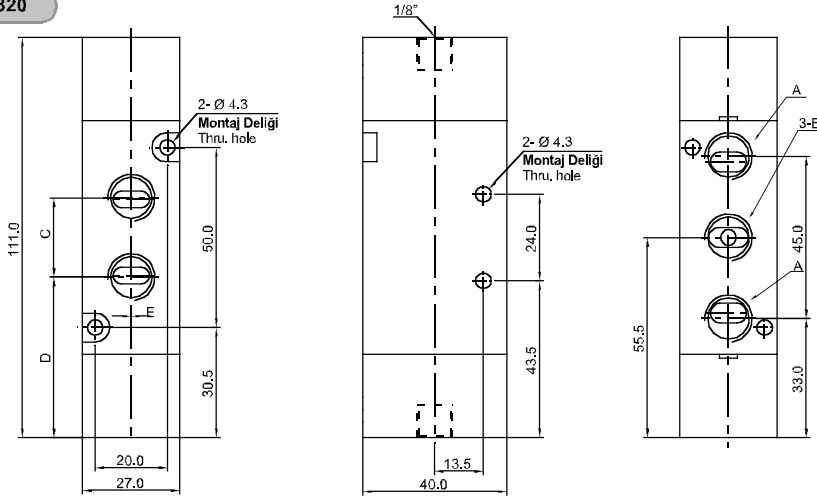

Parça / Model Item / Model	4A320-08	4A320-10
A	1/4"	1/4"
B	1/4"	3/8"
C	22	24
D	44.5	43.5
E	0	4

4A330

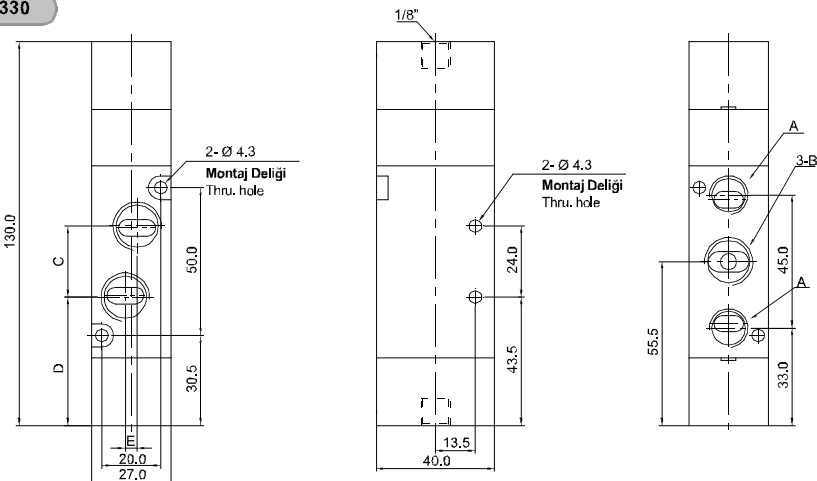

Parça / Model Item / Model	4A330-08	4A330-10
A	1/4"	1/4"
B	1/4"	3/8"
C	22	24
D	44.5	43.5
E	0	4

300 Serisi Solenoid & Hava Kum. Valfler / 300 Series Solenoid & Pneu. Act Valves

Teknik Çizimler / Technical Drawings

4V310

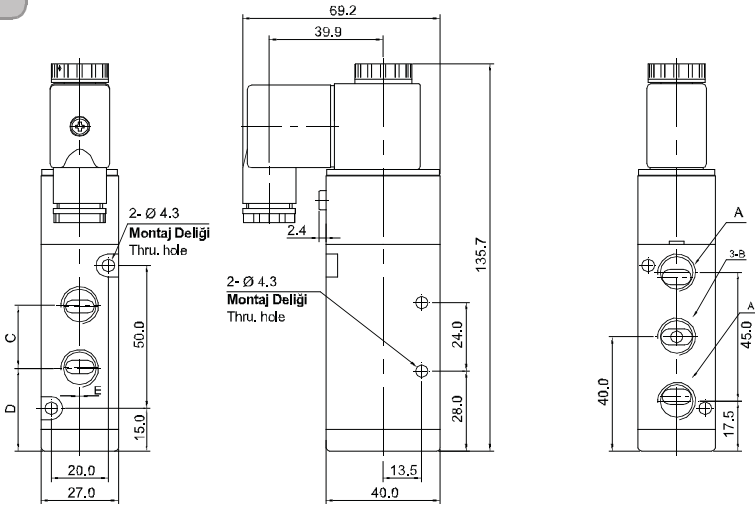

Parça / Model Item / Model	4V310-08	4V310-10
A	1/4"	1/4"
B	1/4"	3/8"
C	22	24
D	29	28
E	0	4

4V320

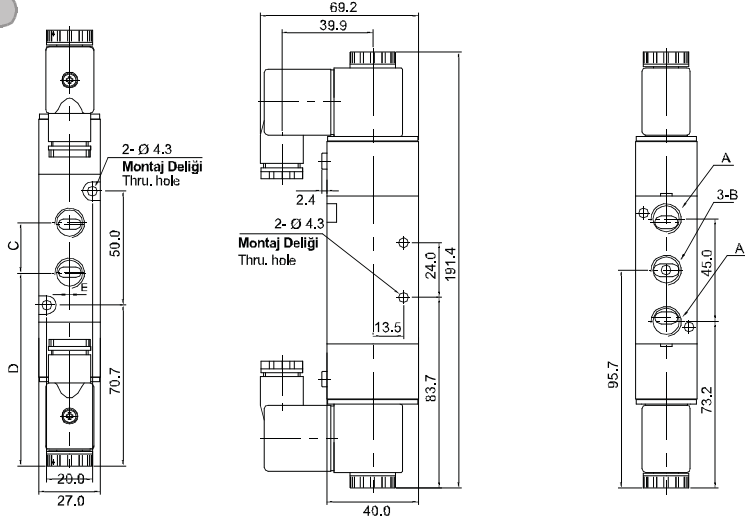

Parça / Model Item / Model	4V320-08	4V320-10
A	1/4"	1/4"
B	1/4"	3/8"
C	22	24
D	83.4	82.4
E	0	4

4V330

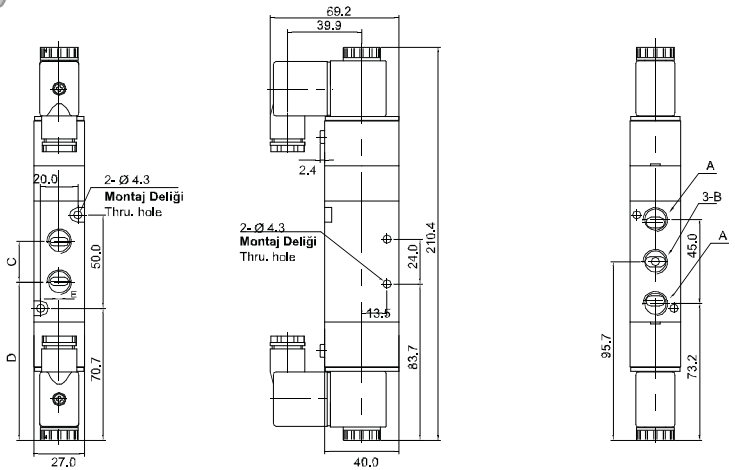

Parça / Model Item / Model	4V330-08	4V330-10
A	1/4"	1/4"
B	1/4"	3/8"
C	22	24
D	102.6	101.6
E	0	4