

C-...GAS-020N-L-...

STANDARD ALUMINIUM MANIFOLDS

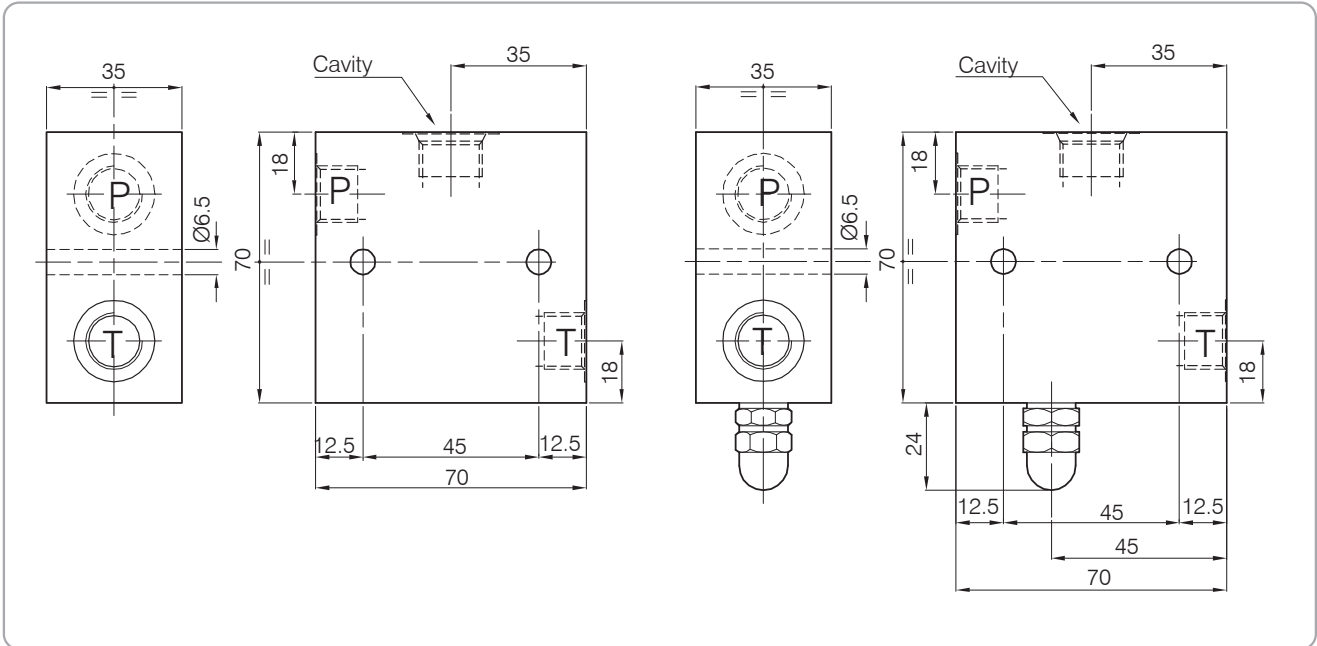

Dimensions

Model Number	Cavity	Port size T-P GAS (BSPP)	Cartridge See page	Coil See page
221	CE-020-N (Ø 15.9mm-7/8"14UNF)	3/8"	7/8 23/24	38
233	CE-020-N (Ø15.9mm-7/8"14UNF)	1/2"		

Ordering Code



Body Number
221
233

Emergency screw
E Emergency screw