

**Push-in Fittings**

**IPZT SERIES**



**Product features**

- It's made of copper pneumatic piping joints
- Not only the body but also the sleeve, both of them are made from copper, which is good for flame resistance, heat resistance and splash performance

**Speciality**

Operating Temperature	-20~+80°C
Operating Pressure	0-1.0MPa
Fluid	Aia, Vacuum
Applicable Tube	Polyurethane and Nylon

**Dimension**

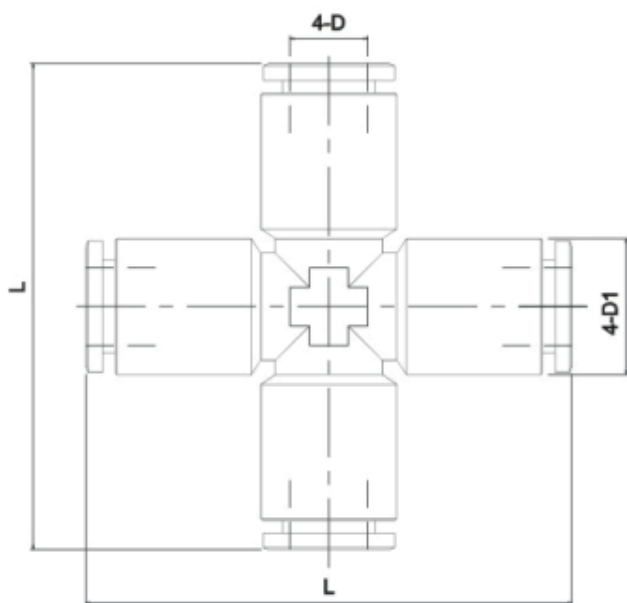

MODEL	$\phi D$	$\phi D1$	L
IPZT 04	4	8.5	35
IPZT 06	6	12	48.5
IPZT 08	8	14	54
IPZT 10	10	16	58
IPZT 12	12	18	63.5