

MINI Fittings

PY-C SERIES



Product features

- The compact fittings used to the pneumatic tube system
- The volume is 40% smaller than the standard pneumatic fittings
- The small and oval sleeve is easy to push in and pull out the tube

Speciality

| | |
|-----------------------|---------------------------------|
| Fluid | Air /no other gases or liquids) |
| Operating Pressure | 0~1.0 MPa (150psi) |
| Negative Pressure | -100Kpa(-29.5 in Hg) |
| Operating Temperature | -60 °C (32-140 °F) |
| Applicable Tube | PU Polyurethane and Nylon |

Ordering Code

PC - 06 - 01 - C

| | | | |
|------------------------------|--------------------------|------------------------------|----------------|
| | | | |
| Compact one touch fitting | Tube Dia Code Size | Thread Size Metric Thread | Compact Nickel |
| | 03 φ03 | Code Size | |
| | 04 φ04 | M3 M3X0.5 | |
| | 06 φ06 | M5 M3X0.8 | |
| | | M6 M6X1.0 | |
| | | R (PT) Thread | |
| | | Code Size | |
| | | 01 R1/8 | |

Note: we can make other smaller thread.

Dimension

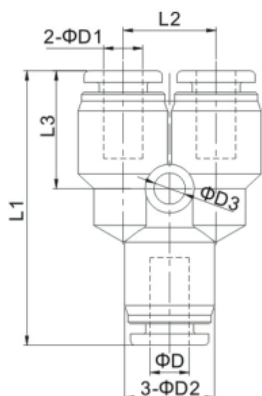

| MODEL | φD | φD1 | φD2 | φD3 | L1 | L2 | L3 |
|----------|----|-----|------|-----|------|-----|-----|
| PY03C | 3 | 3 | 7.5 | 3.2 | 22.7 | 7.8 | 9.5 |
| PY04C | 4 | 4 | 9.5 | 3.2 | 28 | 9.2 | 12 |
| PY06C | 6 | 6 | 11.5 | 3.2 | 30 | 11 | 12 |
| PY06-04C | 6 | 4 | 11.5 | 3.2 | 30 | 11 | 12 |