

## Kartusche Wechselventile - WLSB Serie/Cartridge Shuttle Valves - WLSB Series

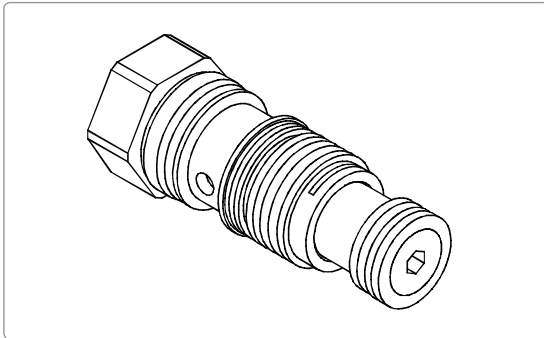

### Spezifikationen/Specifications

Model Nr. Model Number	Operating Pressure (bar)	Max.Ström. Max. Flow (lpm)	Gewicht Weight (Kg)
WLSB-02	350 (5076 psi)	10 (2.64 gpm)	0.14(0.31 lbs)
Flüssigkeitstyp/Fluid Type		ISO VG 32,46,68	
Viskosität cSt/Viscosity cSt		10~ 400 (59~ 1854SSU)	
Betriebstemperatur/Operating Temperature °C		-15 ~ 70 (-5~ 158 °F)	
Verschmutzungsgrad/Contamination Level		ISO4406.21/19/16 NAS1638,10	

### Leistung/Performance

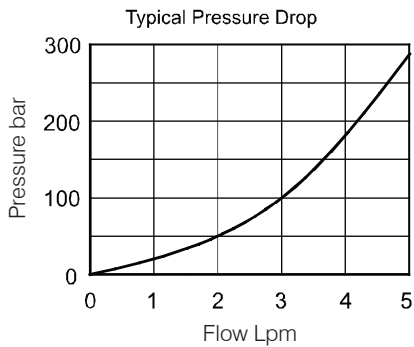

### Wie man bestellt/How To Order

**1** Ventil-Serie/Valve Series  
WLSB=Cartridge Shuttle Valves

**2** Größe der Montageplatte  
Subplate Mounting Size  
02 :T-11A Cavity :CST-11A

### Steuerport (S)/Control Port (S)

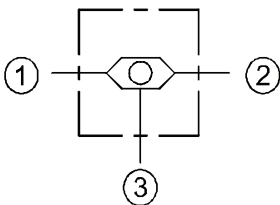

### Maße/Dimensions

